

M2+M2/a+M2/b = PISALNA MIZA = 1 kos

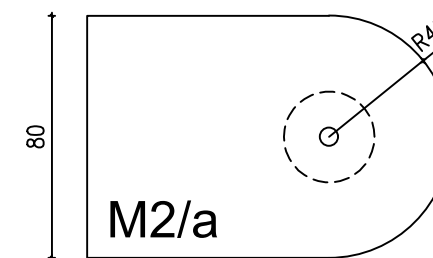
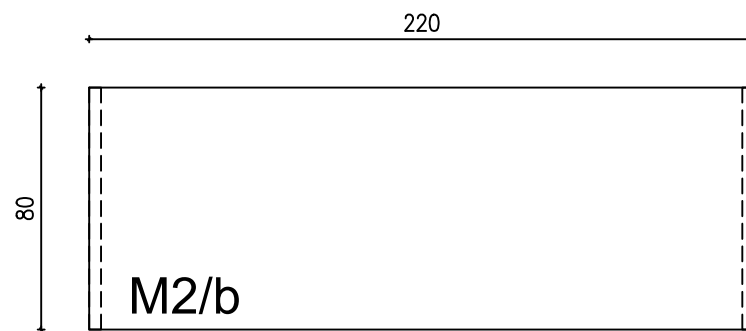
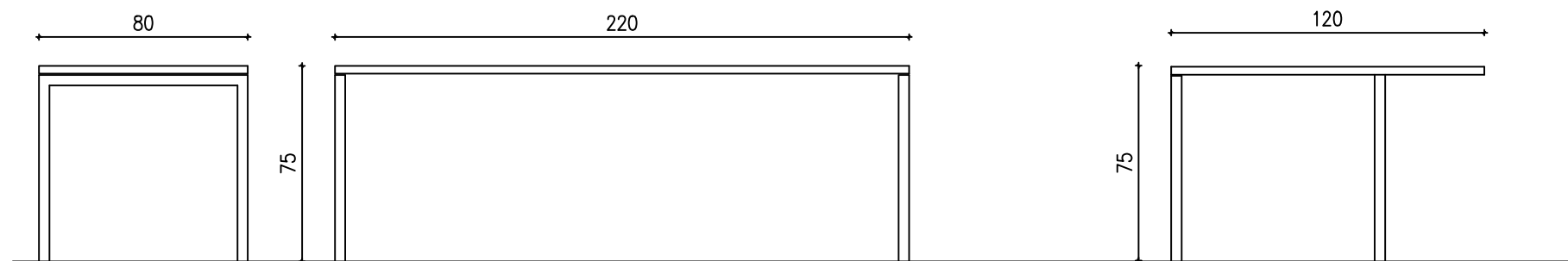
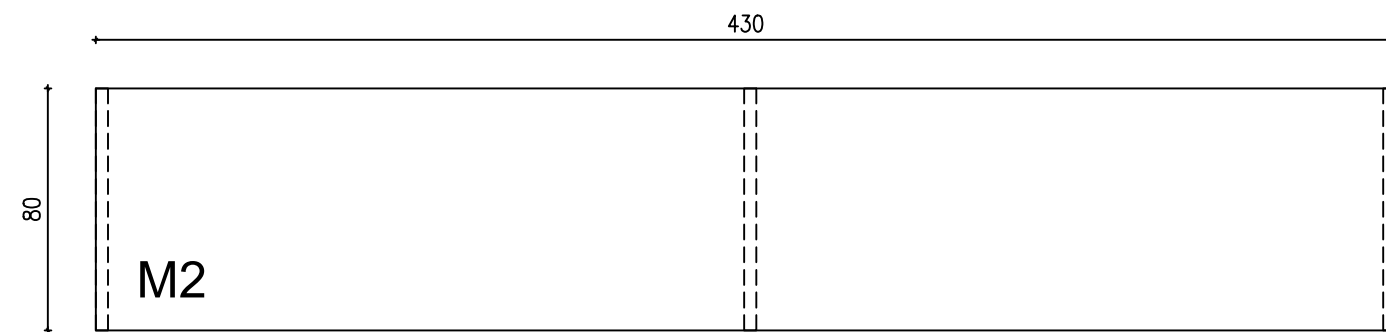
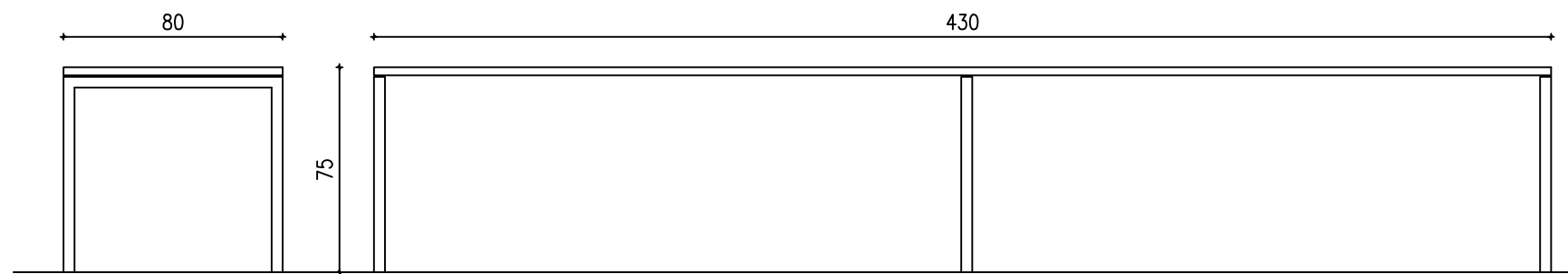

Objekt: PRENOVA BOLNIŠNIČNE LEKARNE V SPLOŠNI BOLNIŠNICI JESENICE			Risba: SCHEME OPREMA-LESENI DEL MIZE IN ČAJNA KUHINJA		
Vrsta projekta: PZI	Datum risbe: junij 2019	Št. projekta: 8234/19/PZI	Št. načrta A-8234/19/PZI	Merilo: 1:25	Št. risbe: 1.2.5.2